

# SERVICE LOCATION RECORD

OPER UNIT	DEPTID	ACCOUNT	RESOURCE	POWER PLT WORK ORDER	ACTIVITY	CUSTOMER	CWO NO	CITY NO	KEY NO	GRID NO	CP NO	PROJ NO
	3177		20028100311	PLSE	PSMC	179184	700	74	AT-02			

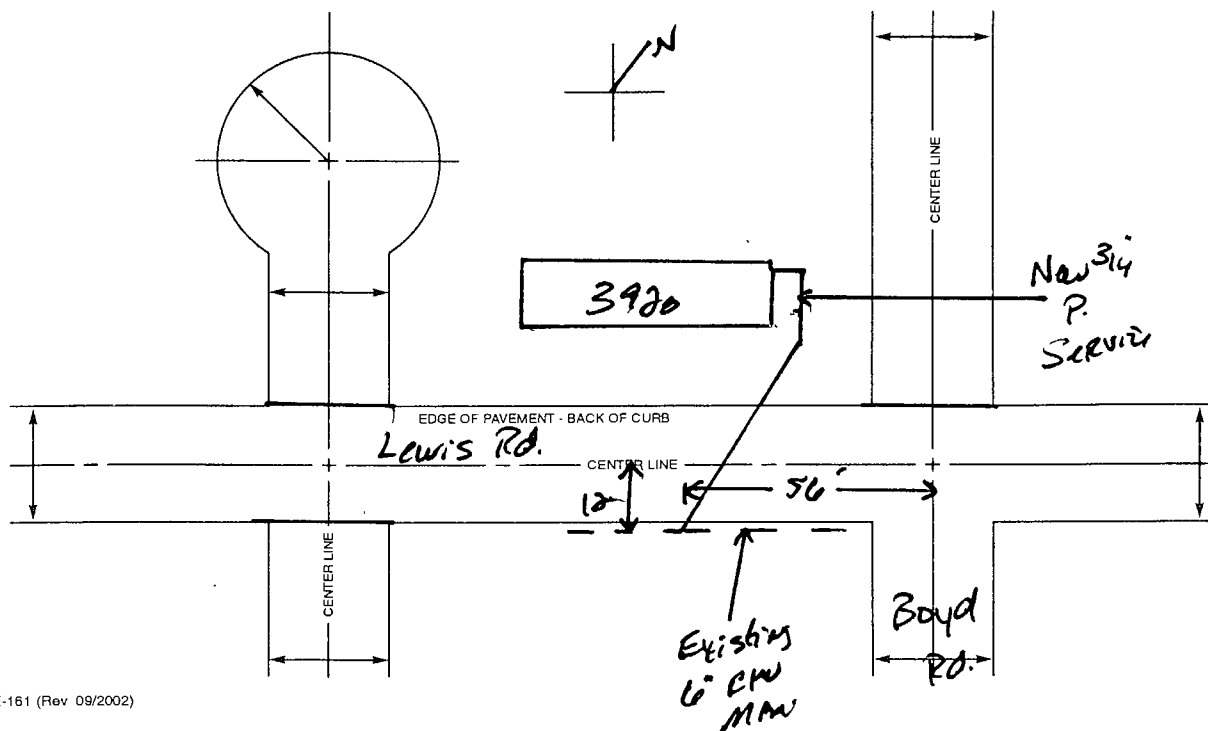

E-161 (Rev 09/2002)

LOCATION	3920 Lewis Rd			CITY	Gastonia		
BETWEEN	Boyd Rd			STREET &	STREET		
	SIZE	TYPE	LENGTH	INSTALLED	RETIRED	RENEWED	
MAIN TO BLDG	3/4"	P	251'	7-17-03			
MAIN TO PROP LINE	3/4"	P	50'				
PROP LINE TO BLDG	3/4"	P	201'				
ENTERS	3920			BRANCHED INTO			
TAP SIZE	1/2	PRESSURE	600 PSI	INCHES W C	LOCATION 56' SW. of center Boyd Rd.		
PRESSURE TEST @ 100 PSI FOR 1/4 HRS BY S. + B							
MAIN SIZE	6"	C I	BARE STEEL	COATED STEEL	PLASTIC	YEAR INSTALLED	
DEPTH	3 FT 0 IN	LOCATION 12' SE of center of Lewis Rd					
"A" P/S READING	1.2			TOTAL ANODES 1#	0	17#	0
REMARKS				L R # 386667			

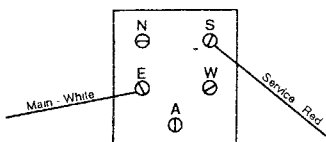

Test Station		
Reading & Location	Lead	Volts
P/S Pipeline Lead - Red New Service	S	
P/S Pipeline Lead - White Existing Main	E	

ENG DEPT USE ONLY